



Fitting Instructions

TOWBAR R35Q
For Rover 45 & MG-ZS
JULY 2004 -

MATERIALS

A	1	Cross Bar
ZQ	1	Neck (ZQ2031)
C1	2	Side Arms (Left Hand - Right Hand)
D	4	M10 x 100mm Bolts, Nuts, Lock Washers and Large Flat Washers (40mm O.D.)
D1	2	Spreader Plates (Left Hand – Right Hand)
D2	4	Bushes (17mm O.D. – 65mm long)
E	4	M10 x 30mm Bolts, 2 Nuts and Lock Washers
F	8	M10 x 35mm Bolts, Nuts, Lock Washers and Large Flat Washers (30mm O.D.)
G	1	M16 x 50mm Bolt, Nut and Lock Washer
G1	2	Spreader Plate
G2	1	Bush (34mm O.D. 12 thick)
J	2	M8 x 30mm Bolts, Nuts, Lock Washers and Large Flat Washers (25mm O.D.)
K	2	M12 x 100mm Bolts and Nyloc Nuts (Grade 10.9- torque setting 139Nm)
BC	12	M10 Bolt Caps

FITTING

1. Remove the floor covering. Remove bumper (5 plastic plugs on top edge of bumper, 2 tip screws and 2 plastic plugs on the lower edge). Remove and discard pressings covering open ends of vehicle frame and temporarily lower the rear exhaust silencer.
2. Insert Side Arms (C1) into chassis and loosely attach using Bolts (J) and drill up for Bolts (D). Temporarily position Spreader Plate (D1), mark around it and remove all mastic compound. Enlarge top-hole (D), insert Bushes (D2) and loosely attach Spreader Plate (D1) with bolts (D). Using Spreader Plate (D1) as a guide, drill for Bolts (F) with Large Flat Washers on the underside of the floor.
3. Loosely attach Main Cross Bar (A) to Side Arms (C1) using Bolts (E), and to the towing eye using Bolt (G) with Spreader Plates (G1) on both sides of towing eye, Tighten all bolts.
4. Refit bumper and exhaust
5. Loosely attach Detachable Neck (ZQ) to Cross Bar (A) as per separate fitting instruction.

Please refer to the vehicle specification for the trailer weight and nose limits, which **must be observed**.

Recommended torque settings: GRADE 8.8 M8 - 27Nm, M10 - 53 Nm, M12 - 95 Nm , M14 - 150 Nm, M16 - 214 Nm
GRADE 10.9 M12 - 139Nm

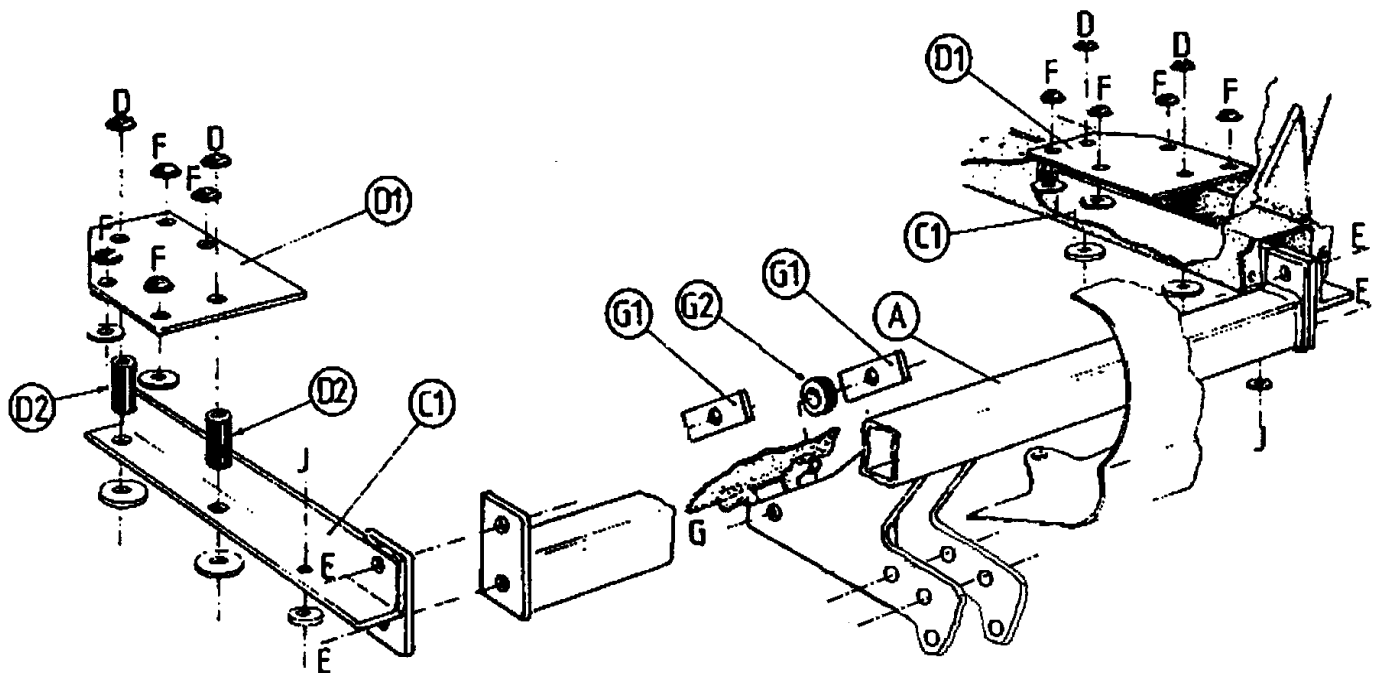



Fitting Instructions

QUANTUM DETACHABLE
TOWBALL SYSTEM
(ZQ XXXX)

MATERIALS

A	1	Receptor/Socket for Towball
T	1	Detachable Towball
K	2	Keys for Detachable Towball
X	4	M12 x 25 x 1.75mm Bolts, Spring Washers and Flat Spacer Washers (25mm O.D)
FC	1	Fixed Weather Cover
RC	1	Removable Weather Cover
L	1	Centreline Label
B	1	Bag
ZQM1	1	Operation Manual

INSTALLATION PROCEDURE

1. Place black plastic fixed weather cap (FC) over forward/ (horizontal system) / upper (vertical system) holes of receptor/socket (A), insert receptor/socket (A) into gap between mounting plates on the towbar, and loosely attach using bolts (X).
 - Notes: (ZEQ1), which is provided as part of the towbar should be refitted on left hand side, together with the electrical socket mounting plate (ZEP1). Only use the 25mm O.D Flat Spacer Washers (X) where there are no loose components attached, i.e. ZEQ1 (electrical socket mounting plate bracket, shown in dashed linetype below).
2. Insert detachable towball unit (T), using procedure detailed in Operation Manual provided, and ensure correct vertical alignment of the towball before fully tightening bolts (X).
3. Attach centreline label (L) to lower edge of bumper.
4. Remove keys (K) from neck of towball, and record the key number in the Operation Manual, together with the fitters name, telephone number, date fitted, vehicle model and registration number and towbar part number.

Bumper Cut – It may be necessary to trim the bumper to allow adequate clearance around the operation handle on the right hand side.

Note: It is essential that the customer/end user is familiar with the operation of the towball system, as detailed in the operation manual, which must be handed to the customer/end user.

Recommended torque settings: M12 - 95 Nm

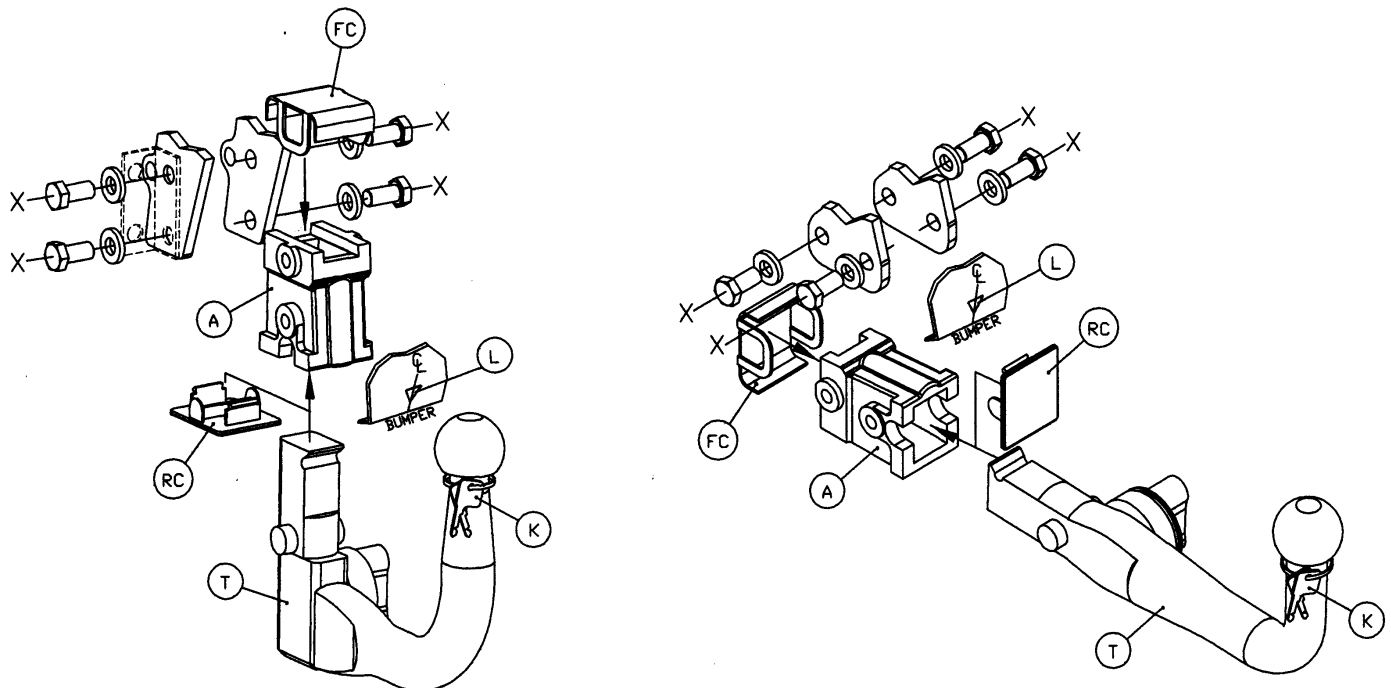

Important – It is essential to ensure that the Operation Manual is in the possession of the end user.