



# Fitting Instructions

TOWBAR PFC3  
For Peugeot 807, Fiat Ulysse  
Citroen C8  
2002 -

## MATERIALS

A	1	Cross Bar
ZQ	1	Detachable Centre Strut with European facing to 94/20/EC A50-1 (ZF3004-A)
D	2	M12 x 35 x 1.75mm Bolts and Lock Washers
D1	2	M12 Cage Nuts
E	1	Left Hand Side Arm
F	1	Right Hand Side Arm
G	2	Angle Cleats
H	2	M10 x 30 x 1.5mm Bolts and Lock Washers
H1	2	M10 Cage Nuts
J	2	Spacer Plates
K	3	M12 x 35 x 1.75mm Bolts and Nyloc Nuts
L	3	M12 x 35 x 1.75mm Bolts and Nyloc Nuts
M	2	M12 x 100 x 1.75mm High Tensile Bolts and Nyloc Nuts (Grade 10.9. - Torque setting 139Nm)
N	1	M10 x 25 x 1.5 Bolt, Nut, Lock Washer and 2 Flat Washers (25mm O.D.)
P	1	Electrical Plate (ZEP1)
R	1	Electrical Plate Angle (ZEQ1)
S	1	M10 x 25 x 1.5mm Bolt, Nut, Lock Washer and 2 Flat Washers (25mm O.D.)
CB	2	M16 x 50mm Coupling Bolts, Nuts, Lock Washers

## FITTING

1. Remove spare wheel. Remove exhaust heat shield. Insert M12 Cage Nuts (D1) into 2 rearmost mounting points. (Inside faces of chassis). Insert M10 Cage Nuts (H1) into forward mounting points. (Rear face of forward cross member and under side of left hand chassis rail. NOTE: Left hand forward mounting point may already have a captive nut fitted).
2. Cut out manufacturers marked area inside bumper. Loosely attach Cross Bar (A) to mounting points on inside faces of chassis using Bolts (D), NOTE: Use Spacer Plates (J) as required to compensate for chassis width variation. Re-fit exhaust heat shield.
3. Loosely attach Angle Cleats (G) to forward mounting points using Bolts (H). Attach Left Hand Side Arm (E) to Cross Bar (A) and left hand Angle Cleat (G) using Bolts (K). Attach Right Hand Side Arm (F) to Cross Bar (A) and right hand Angle Cleat (G) using Bolts (L).
4. Attach Centre Strut (ZF) to Cross Bar (A) using Bolts (M), with Electrical Plate Angle (R) on left hand side, attach Electrical Plate (P) to Electrical Plate Angle (R) using Bolt (N). Ensure lower face of Cross Bar (A) is horizontal. Tighten all bolts. **NOTE:** Bolts (M) have a torque setting of 139Nm.

**Note:** This towbar must be used with either a Witter Towball (part number Z1) or Class A50-1 or A50-X towball dimensionally Conforming to A50-1 with a 'D' and 'S' value greater than or equal to that of the towbar.

Please refer to the vehicle specification for the trailer weight and nose limits, which **must be observed**.

**Recommended torque settings:** GRADE 8.8: M8 - 27Nm, M10 - 53 Nm, M12 - 95 Nm, M14 - 150 Nm, M16 - 214 Nm  
GRADE 10.9: M12 - 139Nm

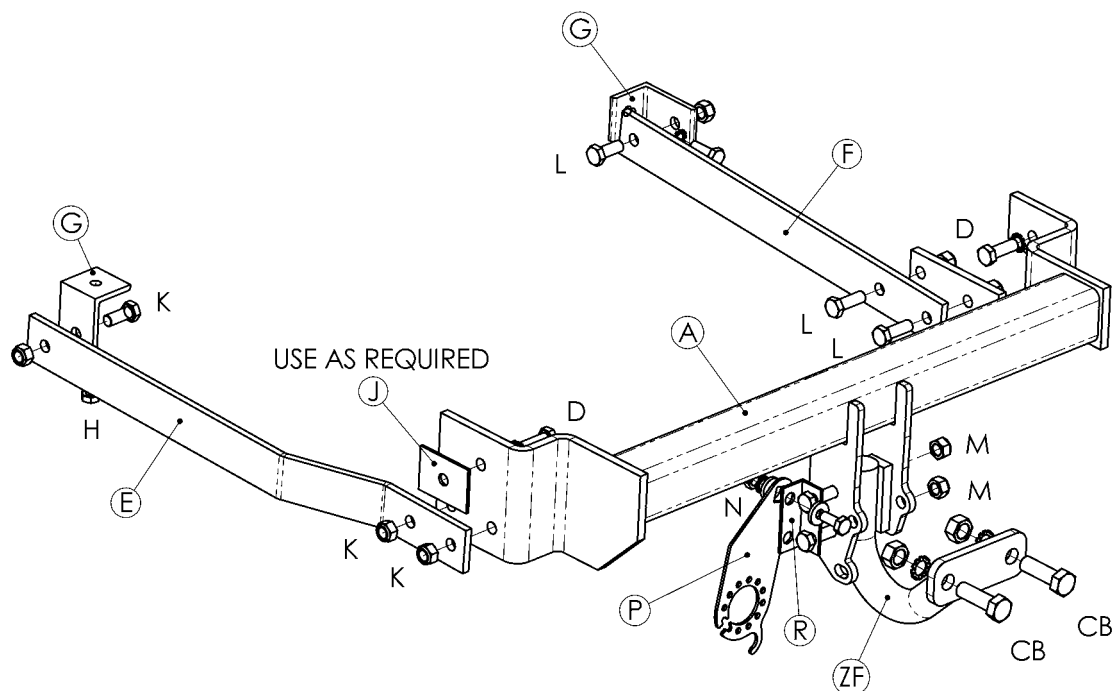



# Fitting Instructions

QUANTUM DETACHABLE  
TOWBALL SYSTEM  
(ZQ XXXX)

## MATERIALS

A	1	Receptor/Socket for Towball
T	1	Detachable Towball
K	2	Keys for Detachable Towball
X	4	M12 x 25 x 1.75mm Bolts, Spring Washers and Flat Spacer Washers (25mm O.D)
FC	1	Fixed Weather Cover
RC	1	Removable Weather Cover
L	1	Centreline Label
B	1	Bag
ZQM1	1	Operation Manual

## INSTALLATION PROCEDURE

1. Place black plastic fixed weather cap (FC) over forward/ (horizontal system) / upper (vertical system) holes of receptor/socket (A), insert receptor/socket (A) into gap between mounting plates on the towbar, and loosely attach using bolts (X).
  - Notes: (ZEQ1), which is provided as part of the towbar should be refitted on left hand side, together with the electrical socket mounting plate (ZEP1). Only use the 25mm O.D Flat Spacer Washers (X) where there are no loose components attached, i.e. ZEQ1 (electrical socket mounting plate bracket, shown in dashed linetype below).
2. Insert detachable towball unit (T), using procedure detailed in Operation Manual provided, and ensure correct vertical alignment of the towball before fully tightening bolts (X).
3. Attach centreline label (L) to lower edge of bumper.
4. Remove keys (K) from neck of towball, and record the key number in the Operation Manual, together with the fitters name, telephone number, date fitted, vehicle model and registration number and towbar part number.

**Bumper Cut – It may be necessary to trim the bumper to allow adequate clearance around the operation handle on the right hand side.**

**Note:** It is essential that the customer/end user is familiar with the operation of the towball system, as detailed in the operation manual, which must be handed to the customer/end user.

**Recommended torque settings:** M12 - 95 Nm

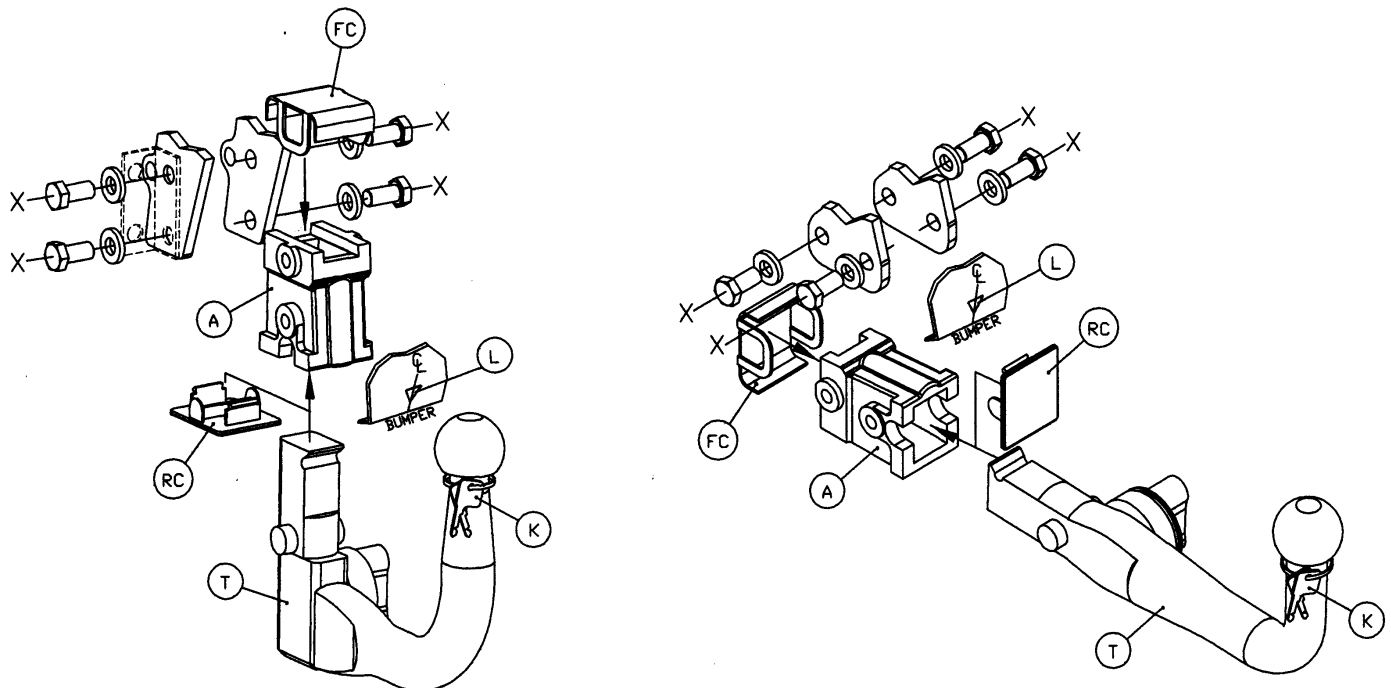

Important – It is essential to ensure that the Operation Manual is in the possession of the end user.